

# DRYWALL LIFT ASSEMBLING

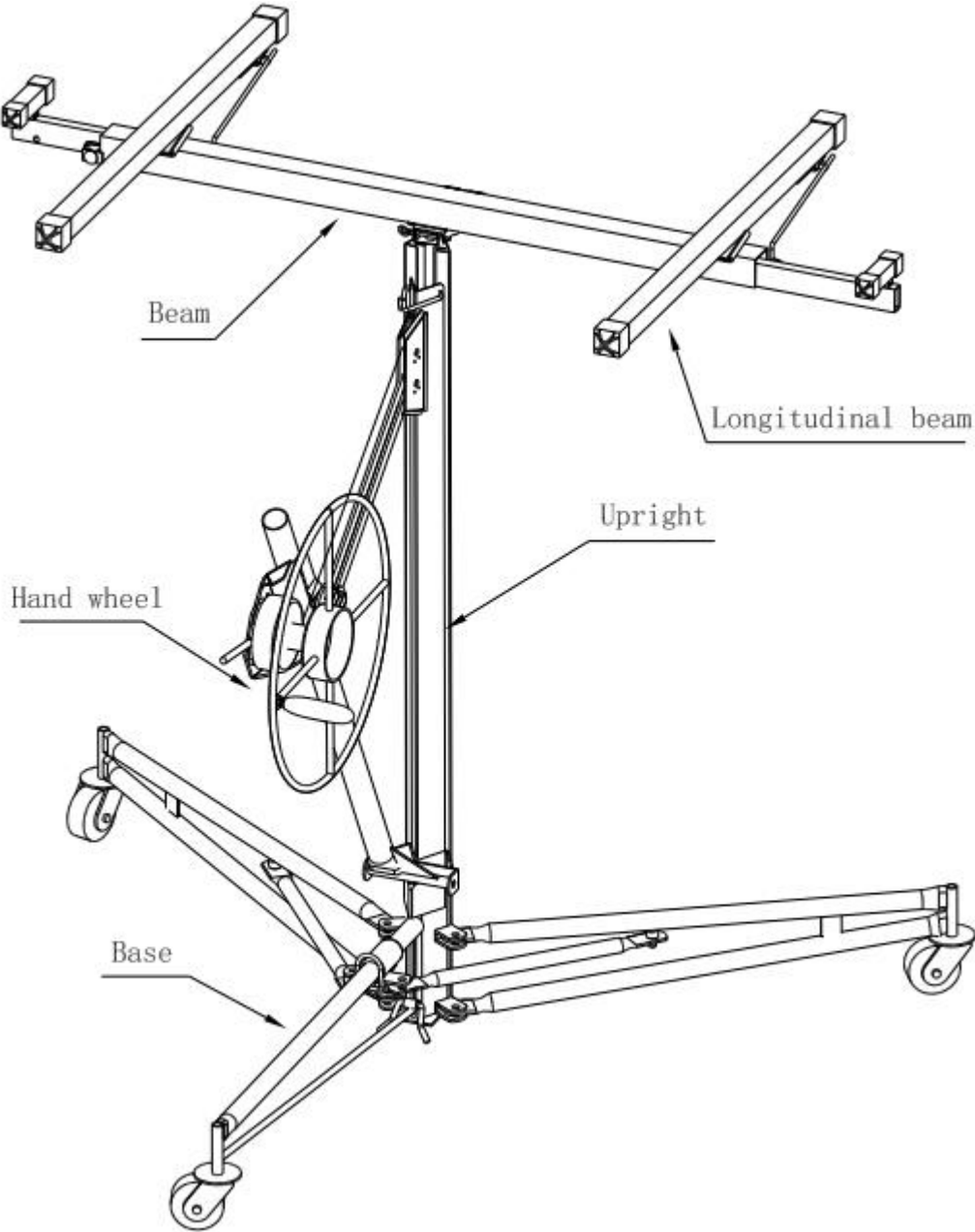

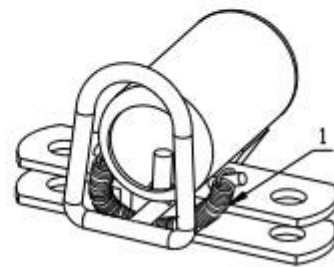

PART NO	DESCRIPTION	QTY	PART NO	DESCRIPTION	QTY
1	Tension spring $\Phi 1 \times \Phi 6.8 \times 65$	1	6	Fold pipe welded pieces	2
2	The base weldments	1	7	Caster wheel	3
3	Pin roll $\Phi 10.5 \times 32$	6	8	Tube stand	2
4	Washer $\Phi 12$	8	9	The base holster	2
5	Cotter pin $\Phi 2.5 \times 25$	8			

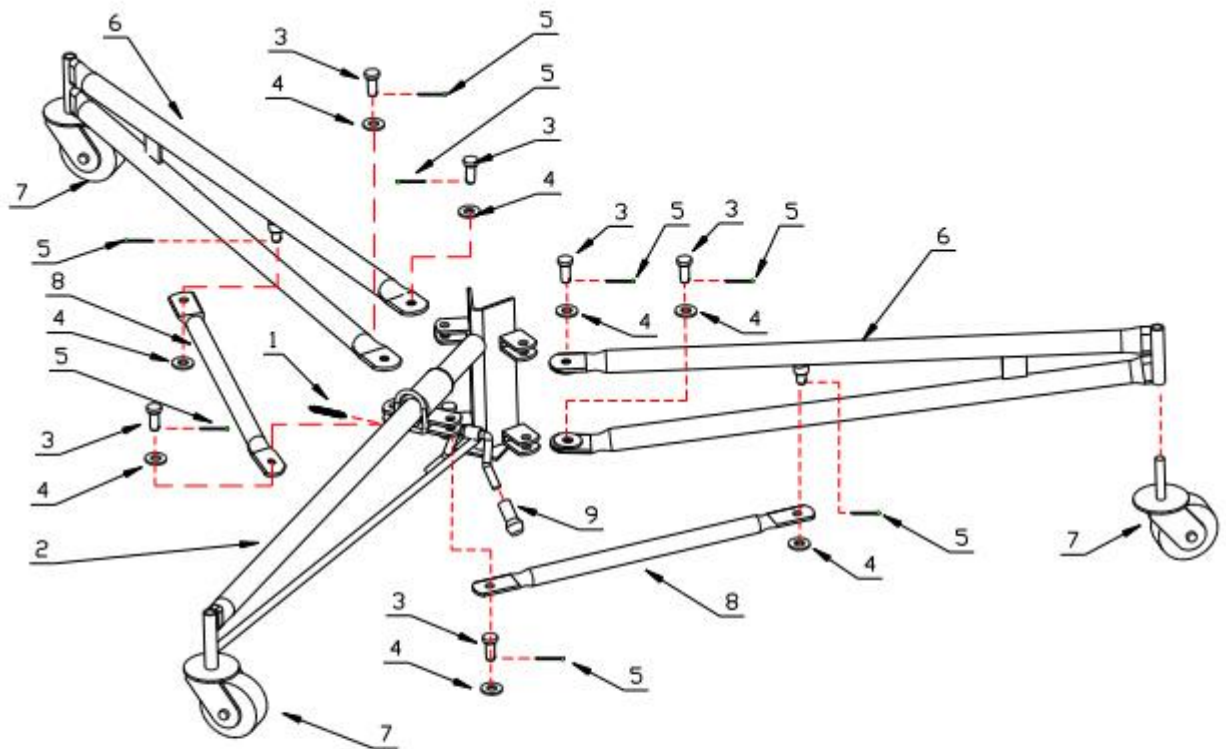
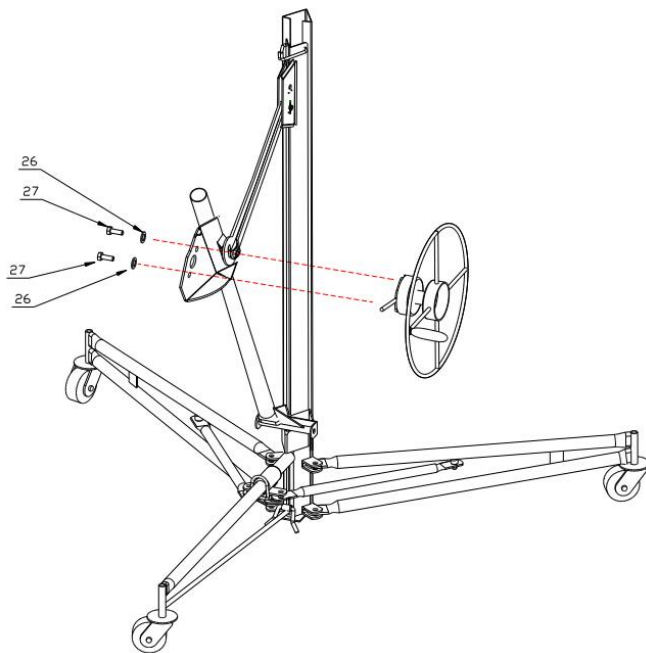
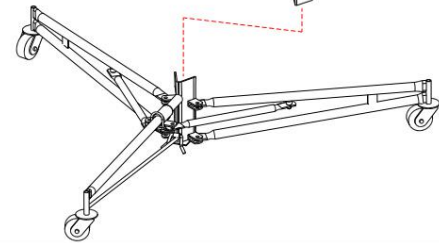
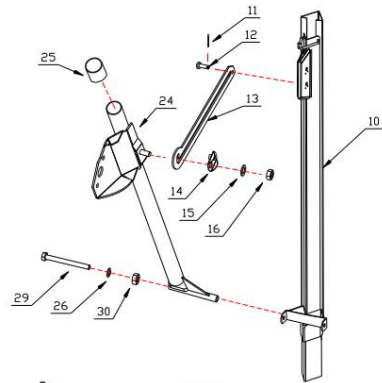
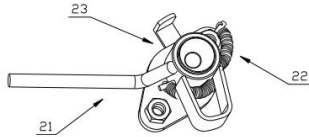
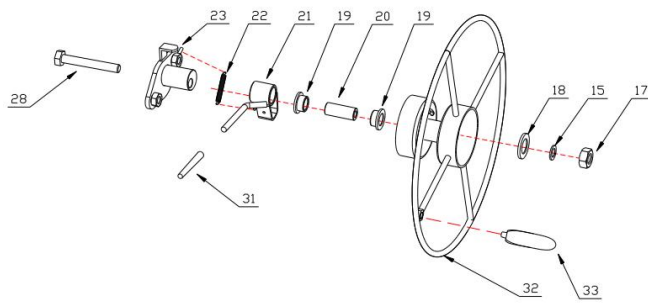

PART NO	DESCRIPTION	QTY	PART NO	DESCRIPTION	QTY
10	Fixed stand weldment	1	22	Tension spring $\Phi$ 1.2x $\Phi$ 8x65	1
11	Cotter pin $\Phi$ 2.5x25	1	23	Eccentric shaft weldment	1
12	Pin roll $\Phi$ 10.5x20	1	24	Adjustable shelf weldment	1
13	Long groove plate	1	25	Adjustable shelf weldment holster	1
14	Safety pad weldment	1	26	Washer $\Phi$ 10	3
15	Washer $\Phi$ 12	2	27	Bolt M10x20	2
16	Nut M12	1	28	Bolt M12x120	1
17	Locknut M12	1	29	Bolt M10x150	1
18	Washer $\Phi$ 35x $\Phi$ 12.5x3	1	30	Nut M10	1
19	Main shaft bushing	2	31	Brake handle holster	1
20	Main shaft	1	32	Hand wheel	1
21	Brake handle weldment	1	33	Handle	1

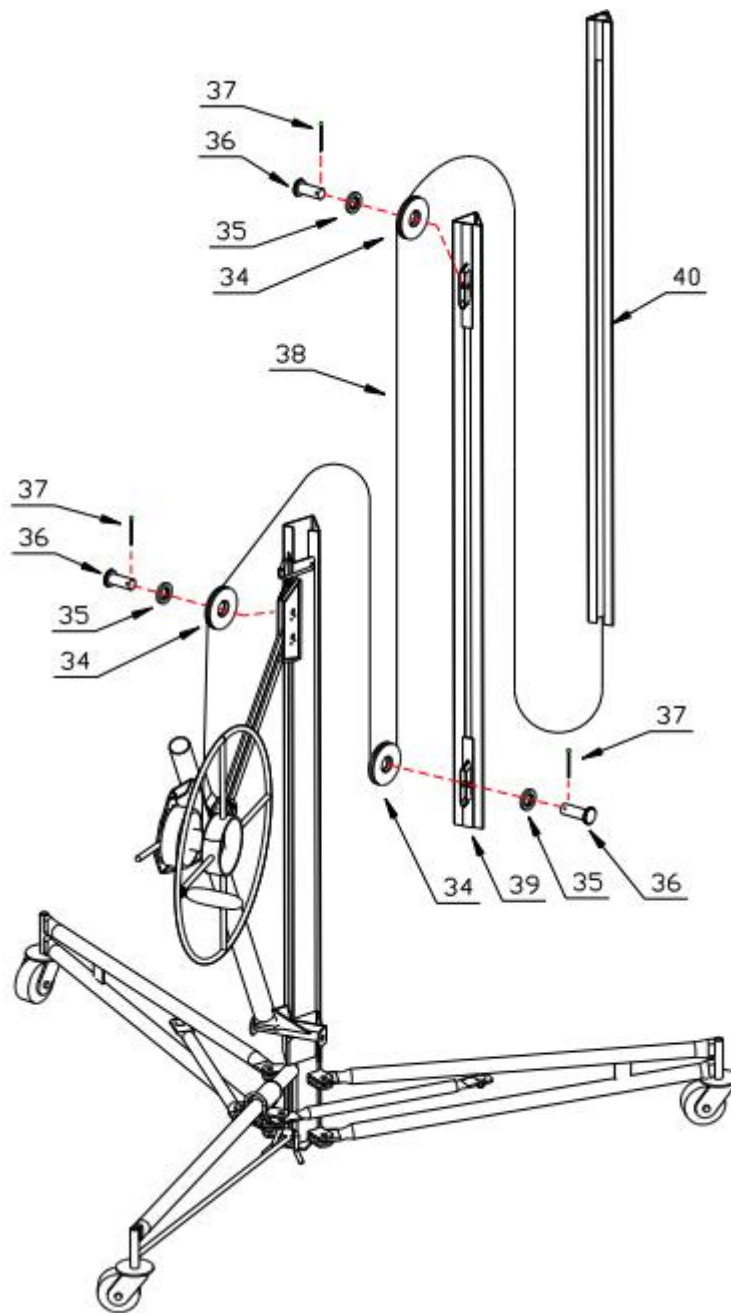

PART NO	DESCRIPTION	QTY	PART NO	DESCRIPTION	QTY
34	Roller wheel	3	38	Steel wire rope	1
35	Roller bush	3	39	Short lift coat welded parts	1
36	Pin roll $\Phi 10.5 \times 20$	3	40	Short lift inside pipe welded parts	1
37	Cotter pin $\Phi 2.5 \times 25$	3			

## How to thread the Steel wire rope

1, Put the Roller bush(35) into the Roller wheel(34), then put into the hall of Short lift coat welded parts(39) which is inside the Fixed stand weldment(10). With the Pin roll(36) insert into the Short lift coat welded parts(39) which is inside the Fixed stand weldment(10), fixed. Insert the cotter pin (37) into the Pin roll(36) and lock it.

2, Take one end of the Steel wire rope(38) from the hand wheel(32), thread the rope from the top of the Roller wheel(34) near the Fixed stand weldment(10), thread the rope from the bottom of the Roller wheel(34) under the Short lift coat welded parts(39), then thread the rope outside-in from the top of the Roller wheel(34) that on the top of the Short lift coat welded parts(39) and pull out .

3, Connect the bottom of the Short lift inside pipe welded parts(40), thread the rope from above and lock it with wire clamp, then fix like the picture.

4, Put all connected parts in to the Fixed stand weldment(10) step by step.

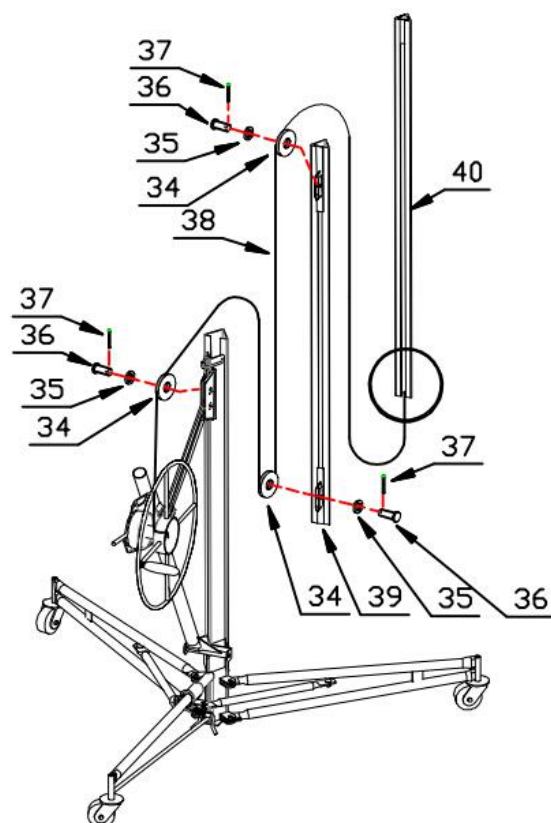
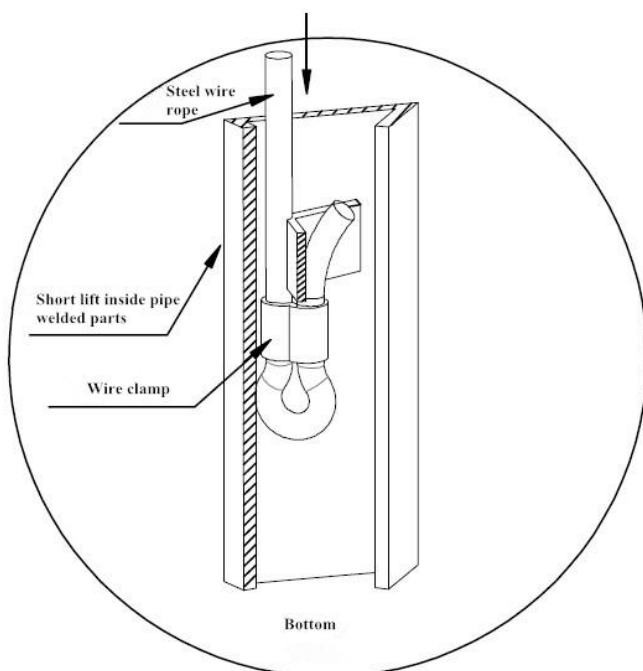

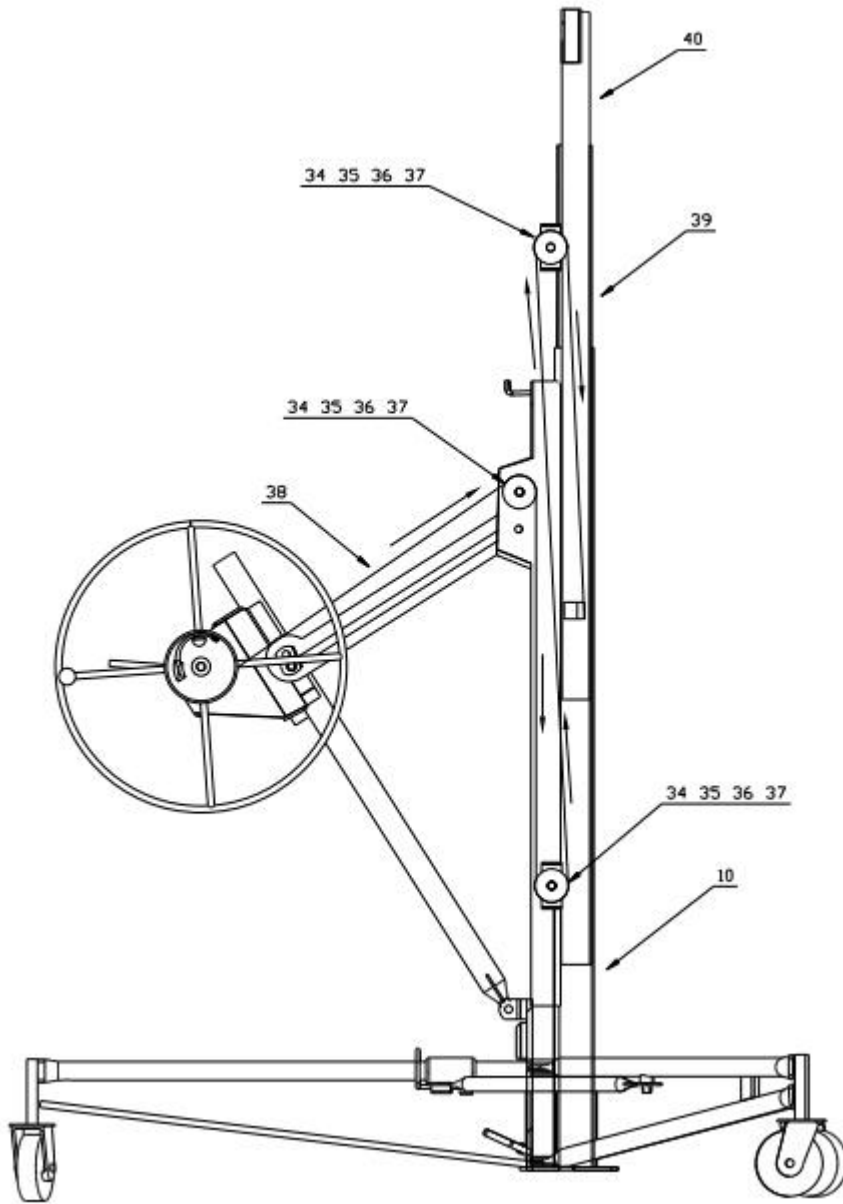

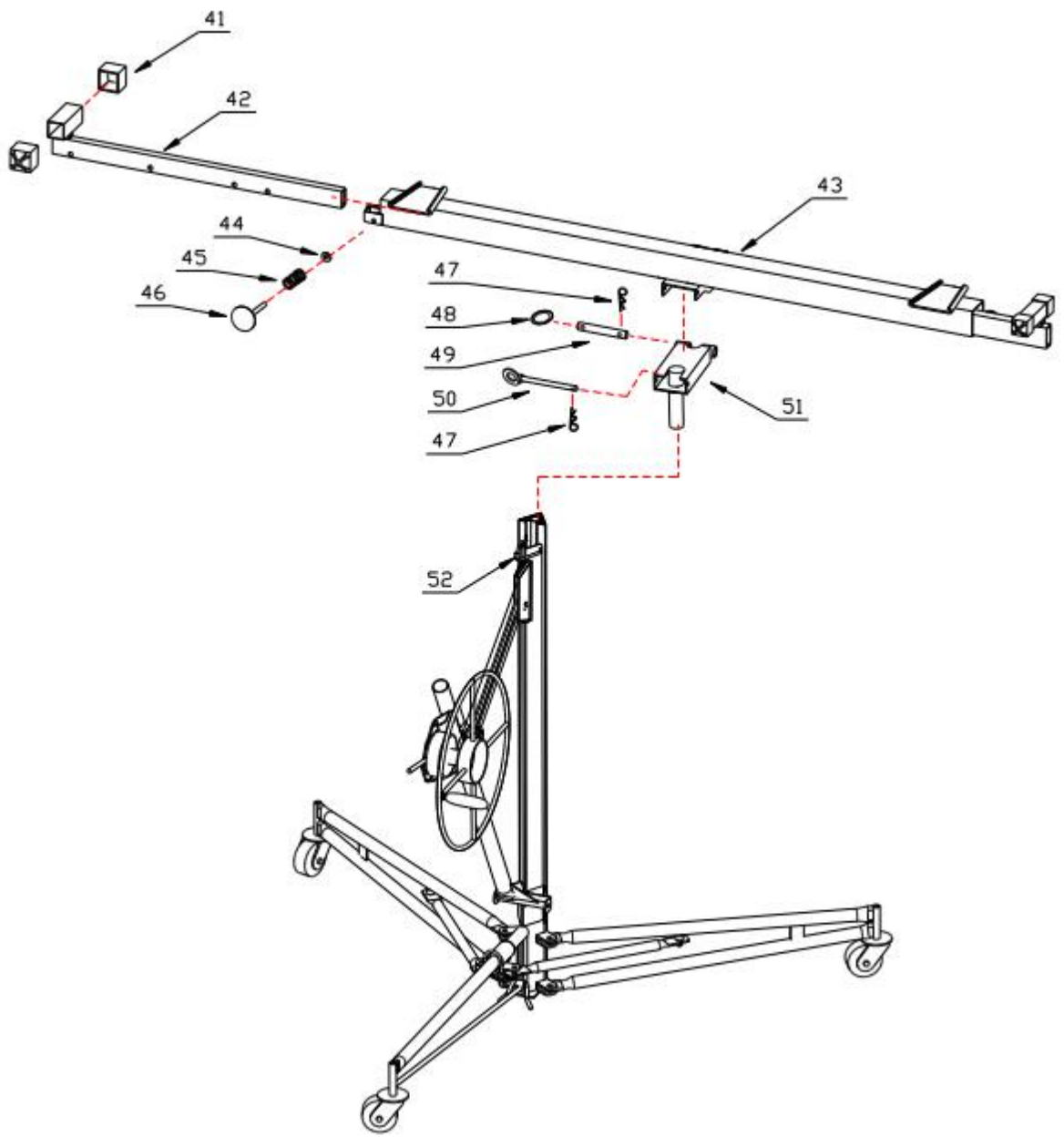

PART NO	DESCRIPTION	QTY	PART NO	DESCRIPTION	QTY
41	Cover gap	4	47	B-pin	2
52	Telescopic pipe weldment	2	48	Key ring	1
53	Beam weldment	1	49	Pin roll $\Phi 14 \times 90$	1
44	Bearing clamp	2	50	Beam pin	1
45	Spring $\Phi 0.7 \times \Phi 9 \times 25$	2	51	Install head weldment	1
46	Safety pin weldment	2	52	Safety hook weldment	1

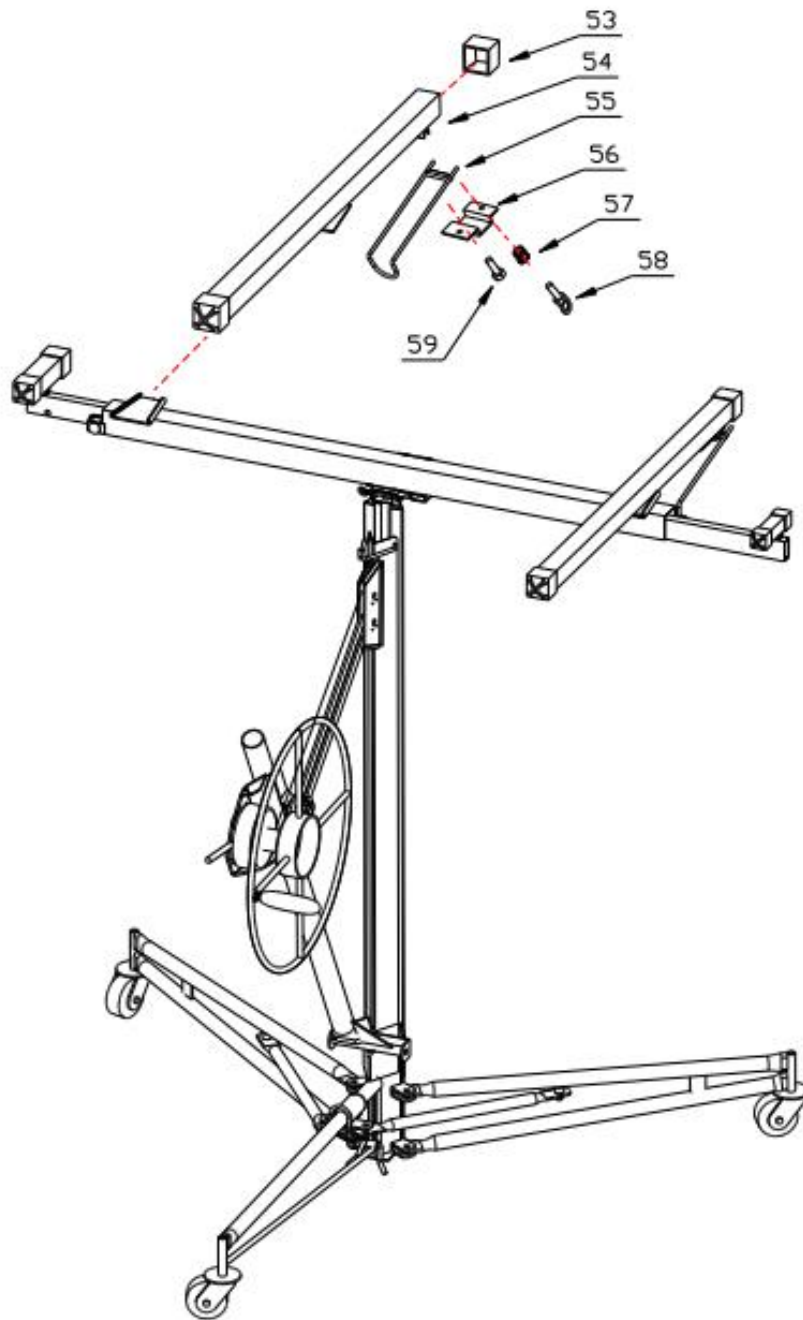

PART NO	DESCRIPTION	QTY	PART NO	DESCRIPTION	QTY
53	Cover gap	4	57	Spring $\Phi 2.5 \times \Phi 15 \times 20$	2
54	Longitudinal beam weldment	2	58	Bolt weldment	2
55	Hook pipe weldment	2	59	Bolt M8x20	2
56	Press plate	2			